

## 10. TRANSMITTERS

### TRANSMITTERS (Fig. 46):

A family of state-of-the-art transmitters, each transmitter is custom encoded with installed battery. Offered in two styles to suit your personal preference.

- Mini (2-or 4-channel)
- Micro (3-channel) with keyring attachment.

### TRANSMITTER MOUNTING:

The transmitters can be conveniently mounted inside your car using the visor clip or on the wall using the mounting plate.

#### Visor Clip (Fig. 47)

- Snap visor clip into transmitter.
- Affix assembly to visor.

*Note: If you do not need the visor clip, install the visor compartment cover.*

#### Mounting Plate (Fig. 48)

- Secure the mounting plate to area using screw and anchor.
- Snap the visor compartment cover.
- Slide the transmitter into the mounting plate, which will hold it firmly in place.

### MULTIPLE TRANSMITTERS: (Fig. 49)

Each transmitter comes factory programmed with random codes. 2-channel transmitters have 2 different random codes, one per button, 3-channel transmitters have 3 different random codes and 4-channel transmitters have 4 different random codes, one per button. Transmitters that are purchased separately as accessories have random codes that must be changed in order to match the code of the "active" transmitter, which you are already using. Below are instructions for transferring an active code from a button on one transmitter to a button of your choice on another transmitter.

- Connect the transmitter with active code to the new transmitter using the programming connector. (Fig 49)
- Press and hold the selected channel button on the transmitter with the active code.
- Press and hold the respective channel button on the new transmitter. The light in the transmitter initially starts blinking and then illuminates continuously after 1-2 sec. Code transfer is completed.
- Programming connector can be removed and both transmitters can now be used to operate the same opener.

**NOTE:** For multi-button transmitters, be sure to carry out this procedure for all the buttons you desire to use.

### CHANGING THE CODE: (Fig. 50)

The transmitter factory preset code can be changed as follows:

- Insert the programming connector into transmitter terminal.
- Short one of the outer pins of the programming connector with the middle pin.
- Press and hold the respective channel button. The light will blink rapidly for approx. 5 sec. Release the button after the light illuminates continuously. Then remove the programming connector.
- Code will change in approximately 2 seconds.
- Release button after the light illuminates continuously, then remove the cable and replace the cover.

**NOTE:** For multi-button transmitters, be sure to carry out this procedure for all the buttons you desire to use.

### BATTERY REPLACEMENT: (Fig. 51)

- Open the transmitter by using small coin.

Fig. 46

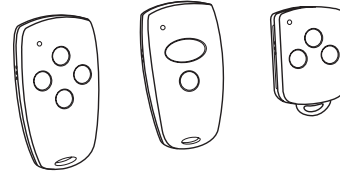

FCC Certified: This device complies with Part 15 of the FCC rules. Operation is subject to the following two conditions: (1) this device may not cause harmful interference, and (2) this device must accept any interference received, including interference that may cause undesired operation. Changes or modifications not expressly approved by the party responsible for compliance could void the user's authority to operate the equipment.

Fig. 47

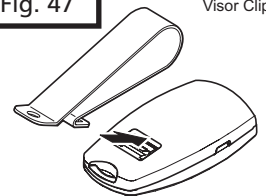

Fig. 48

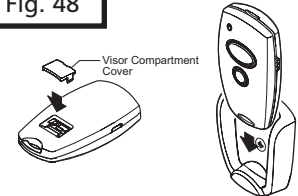

Fig. 49

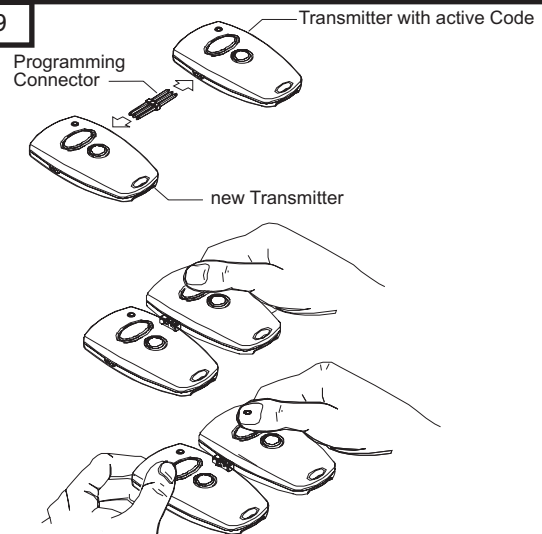

Fig. 50

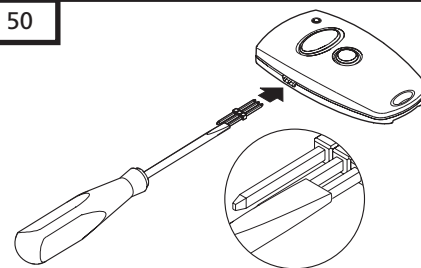
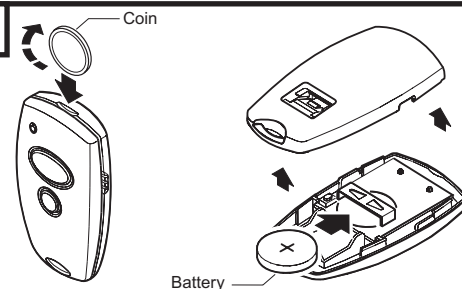

Fig. 51



- Insert a 3V battery (type CR2032) as shown.

- Close the transmitter.

**NOTE:** Replace batteries with same type only.